



GLEN ELLYN
PARK DISTRICT

Panfish Playground Open House

July 7, 2025



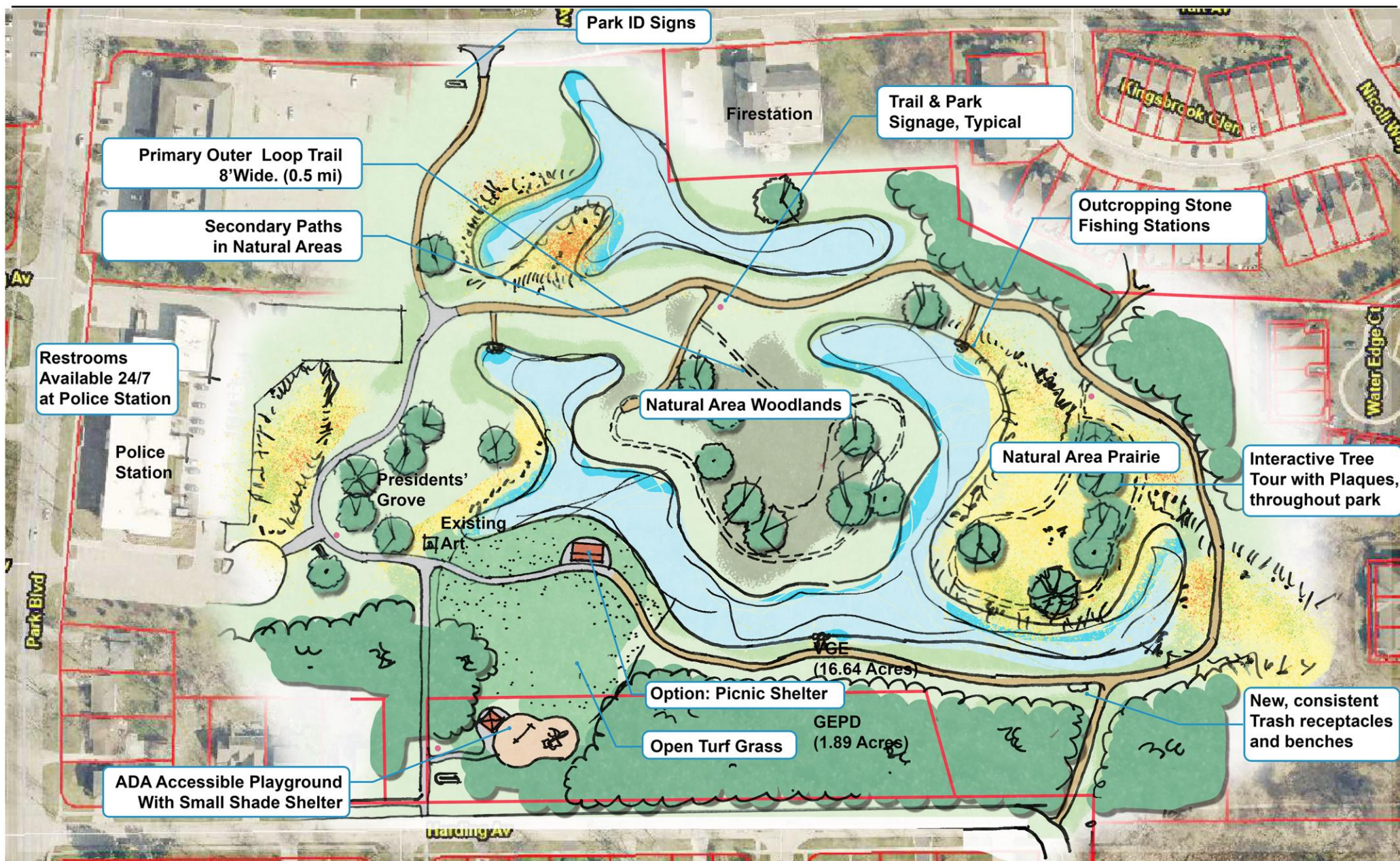

Disclaimer: These drawings are conceptual only and for the convenience of reference. Final plans will be based on public input, site constraints, permitting process and budget.

11.15.2024

Panfish Park Master Plan Concept

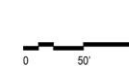

Glen Ellyn Park District Panfish Park

Design • Build • PLAY!



Color Palette:
Forester

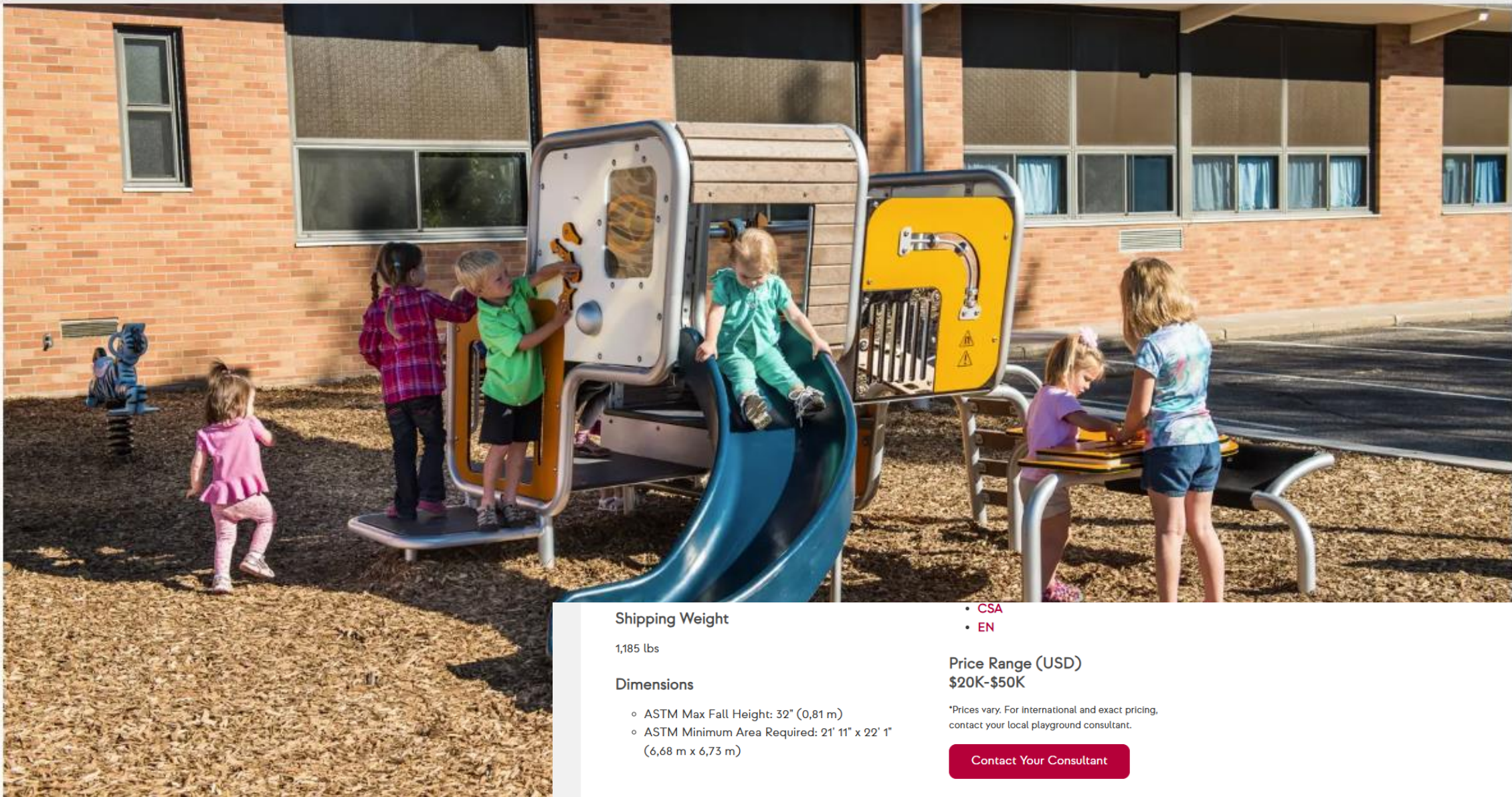

Shipping Weight

1,185 lbs

Dimensions

- ASTM Max Fall Height: 32" (0,81 m)
- ASTM Minimum Area Required: 21' 11" x 22' 1" (6,68 m x 6,73 m)

- CSA
- EN

Price Range (USD)
\$20K-\$50K

*Prices vary. For international and exact pricing, contact your local playground consultant.

Contact Your Consultant

Co-Op Park Playground Glen Ellyn, IL

Design • Build • PLAY!



SPECS



SALE!

Gladstone

\$13,864 ~~\$25,200~~

SPECS



SALE!

Travelers Pass

\$13,871 ~~\$25,221~~

SPECS



SALE!

Canyon Ridge

\$14,368 ~~\$26,232~~

SPECS



SALE!

Coghill with Shade

\$15,745 ~~\$20,620~~

SPECS



ECHO Toddler

\$15,999

SPECS



ECHO Toddler

\$15,999

Existing

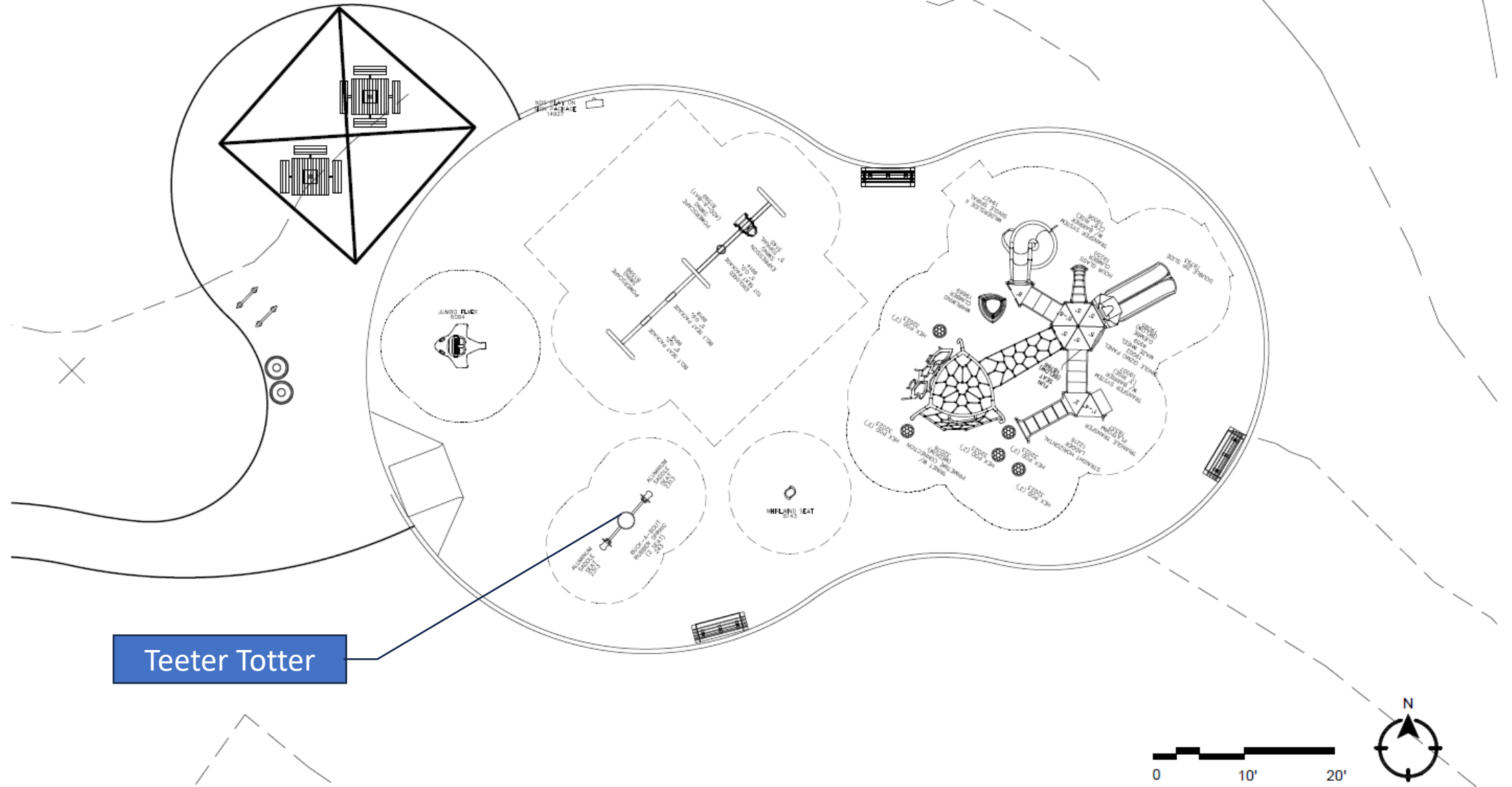

With Newton Toddler Equipment

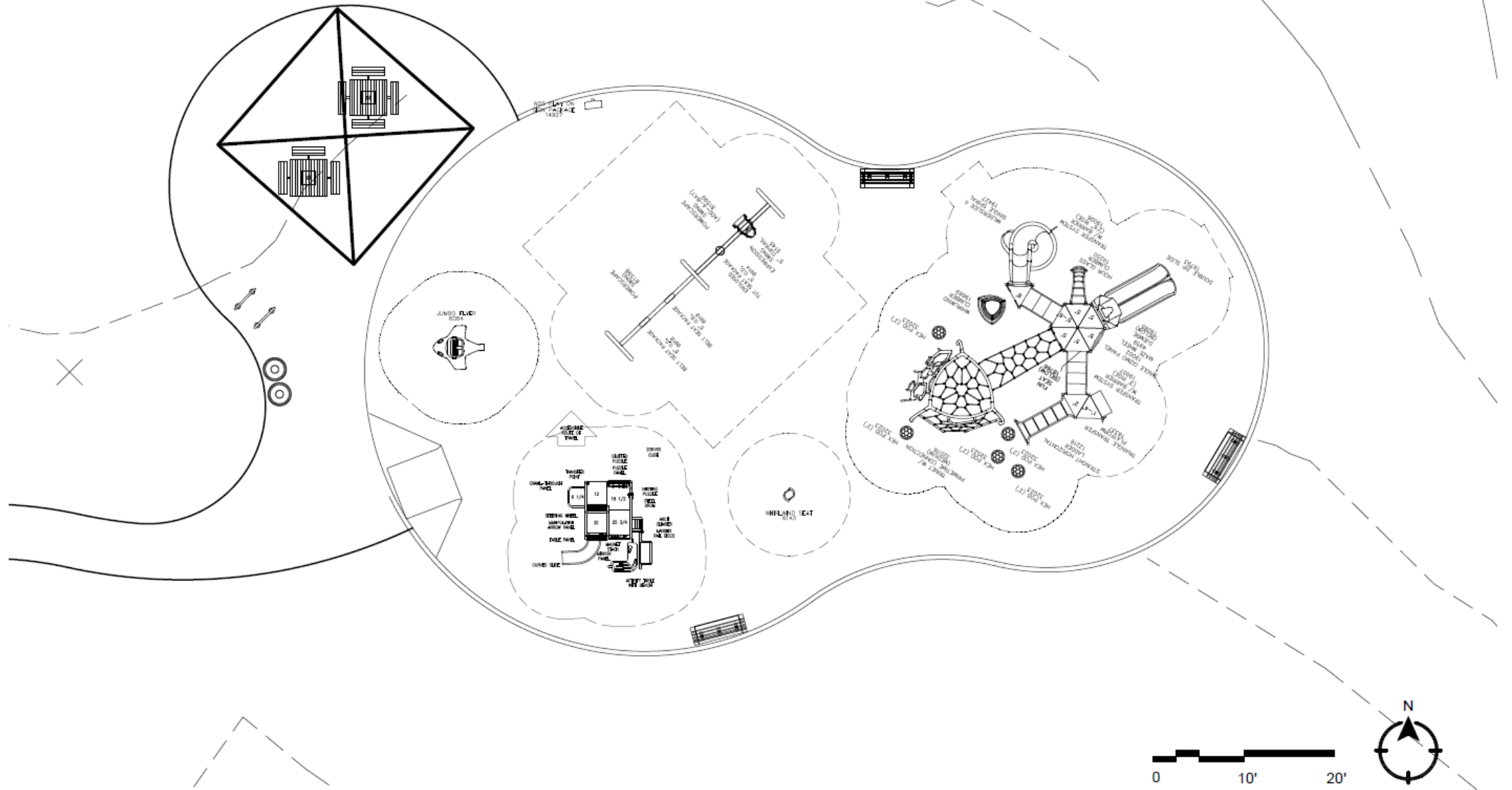

Summary

- Toddler (2to5 year-old) focused.
- Small slide
- Game activities
- Shade attached to equipment



2-5-Year-Old Idea 1

Landscape Structures Motion

*Preferred by group

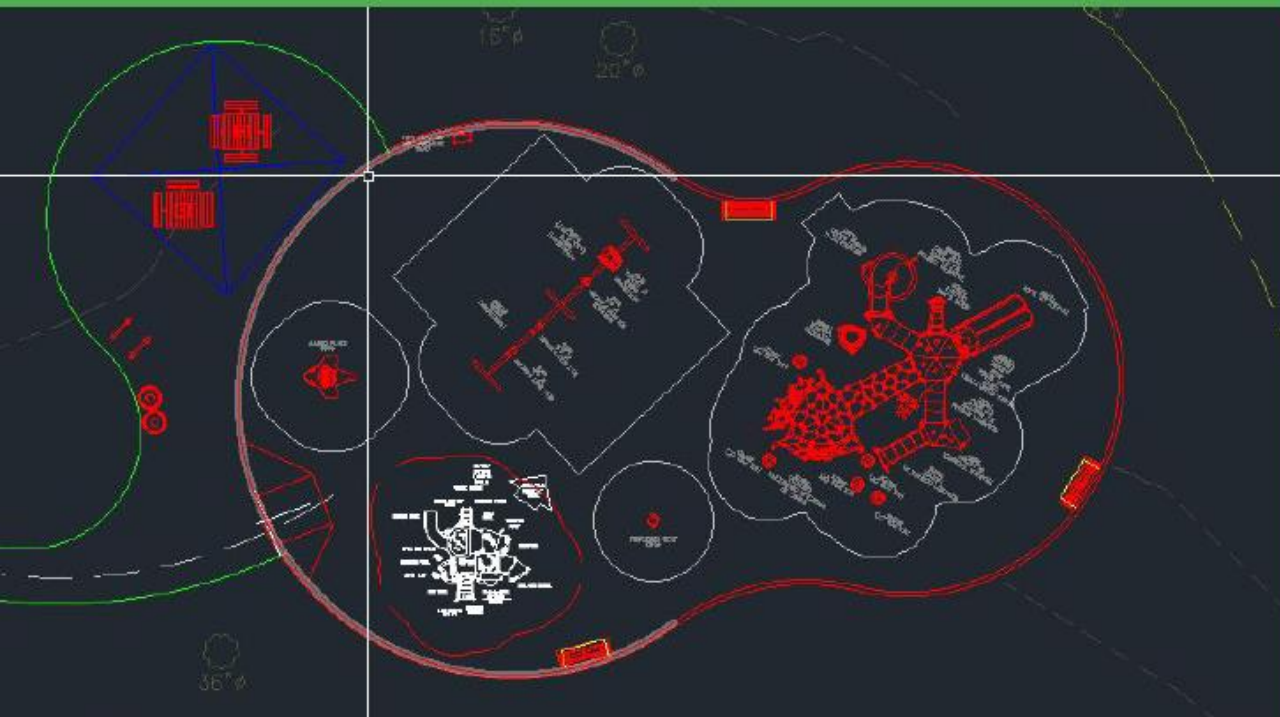

\$34,600

(\$24,700 equipment + install)

Next Steps

- Design and engineer north improvements to construction documents
 - Trail work
 - Signage
 - Benches, trash cans and amenities
- Bid and award north improvements to contractor [2026]
- Depending outcome of bid, possibly use balance to purchase toddler focused equipment
- With Village concurrence and advancement of payment, toddler focused equipment could be purchased ahead of time

Nathan Troia

Director of Planning and Natural Resources

630-858-2462

ntroia@gepark.org



Thank You

Questions / Discussion



Master Plan Discussion

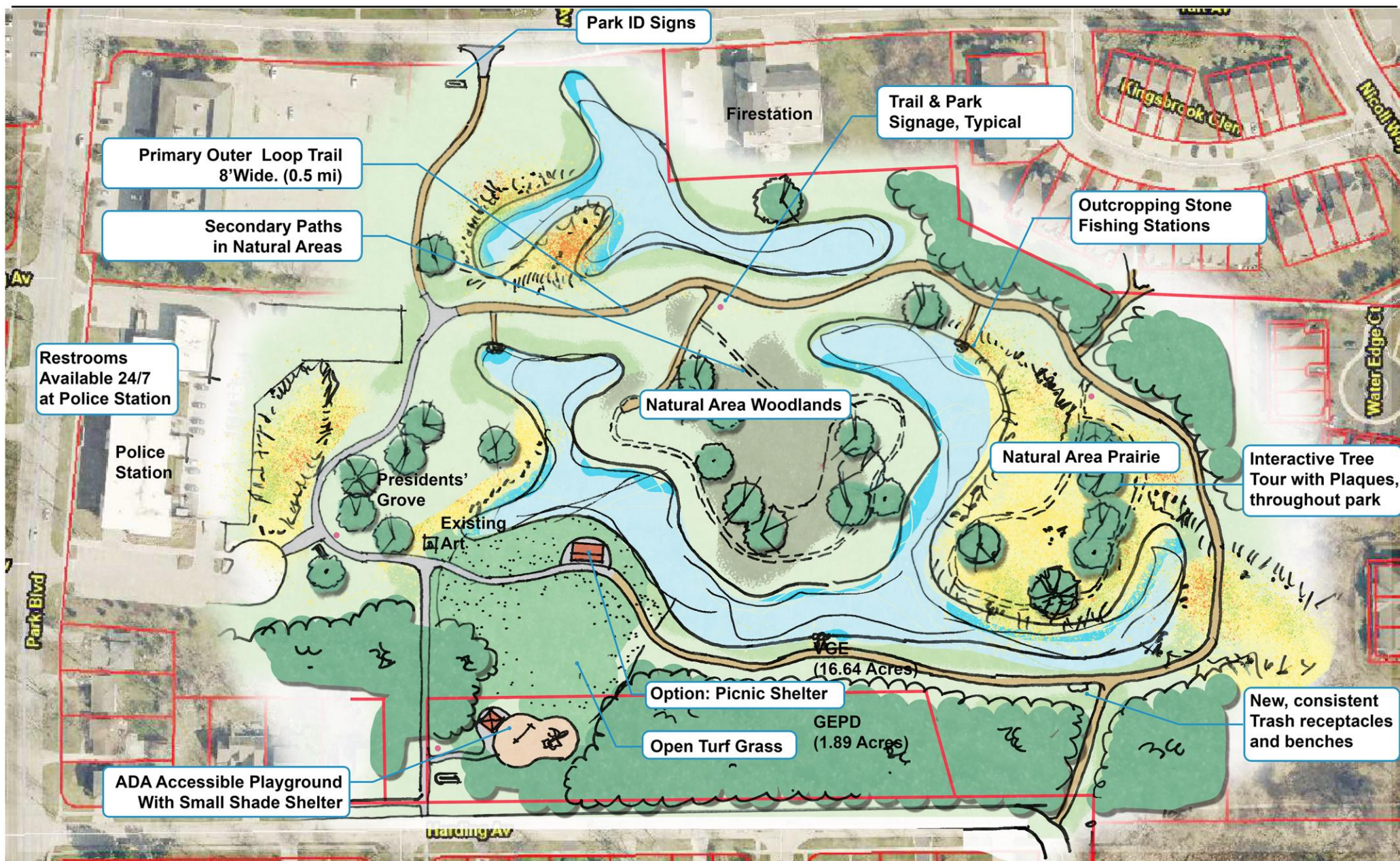

Panfish Park

Master Plan Concept

Disclaimer: These drawings are conceptual only and for the convenience of reference. Final plans will be based on public input, site constraints, permitting process and budget.

11.15.2024

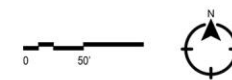

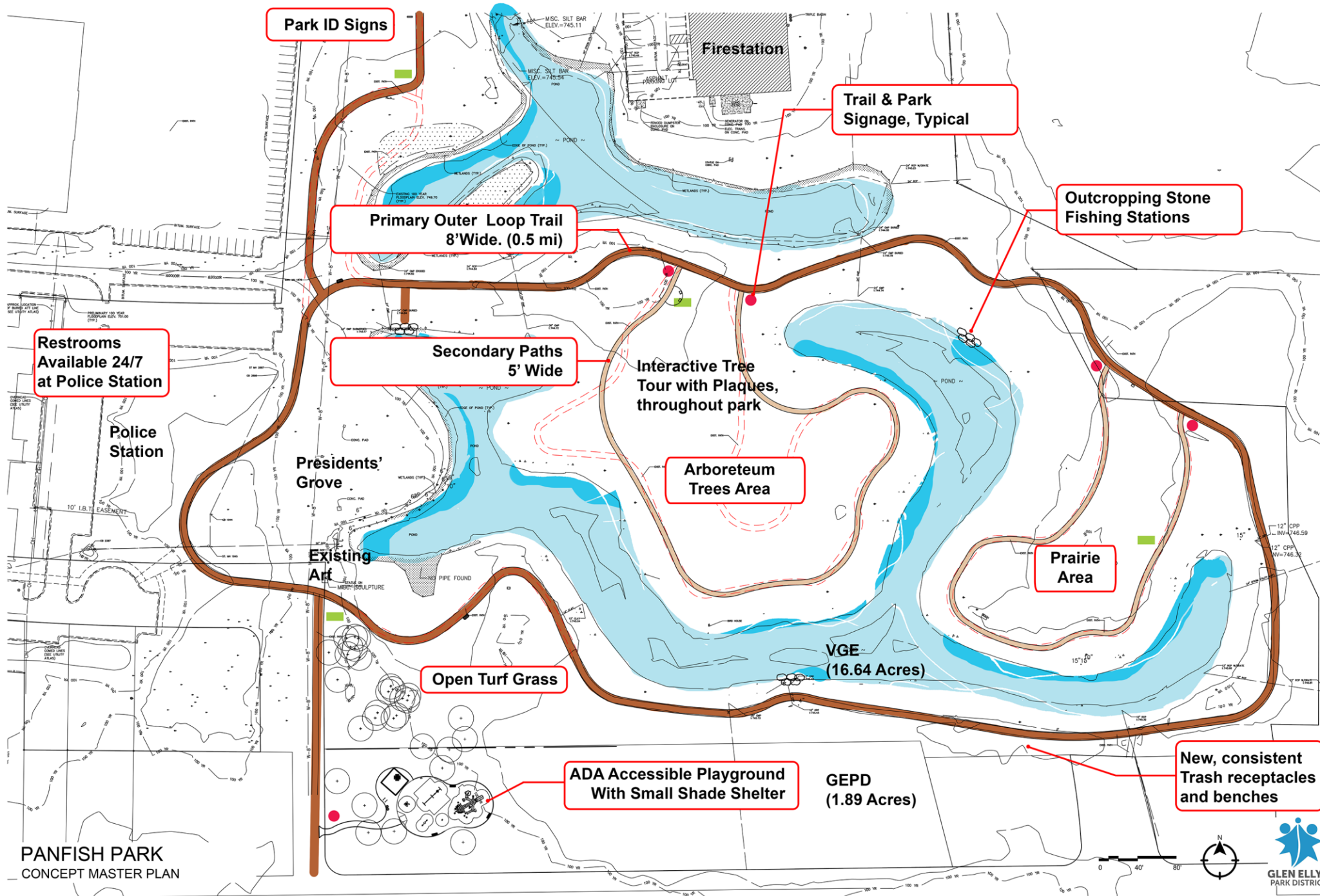

Park ID Signs

Firestation

Trail & Park
Signage, Typical

Outcropping Stone
Fishing Stations

Primary Outer Loop Trail
8'Wide. (0.5 mi)

Restrooms
Available 24/7
at Police Station

Police
Station

Secondary Paths
5' Wide

Interactive Tree
Tour with Plaques,
throughout park

Arboretum
Trees Area

Presidents'
Grove

Existing
Art

Prairie
Area

Open Turf Grass

VGE
(16.64 Acres)

ADA Accessible Playground
With Small Shade Shelter

GEPD
(1.89 Acres)

New, consistent
Trash receptacles
and benches

PANFISH PARK
CONCEPT MASTER PLAN



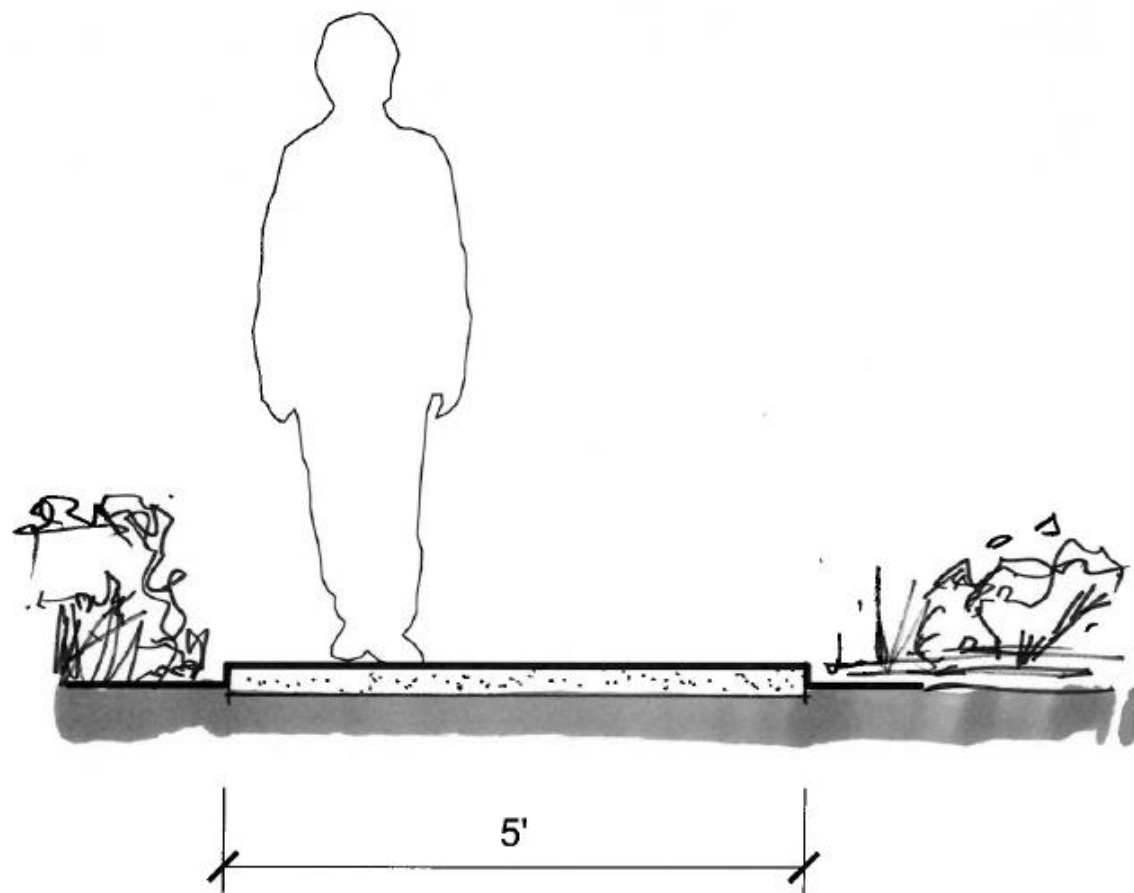
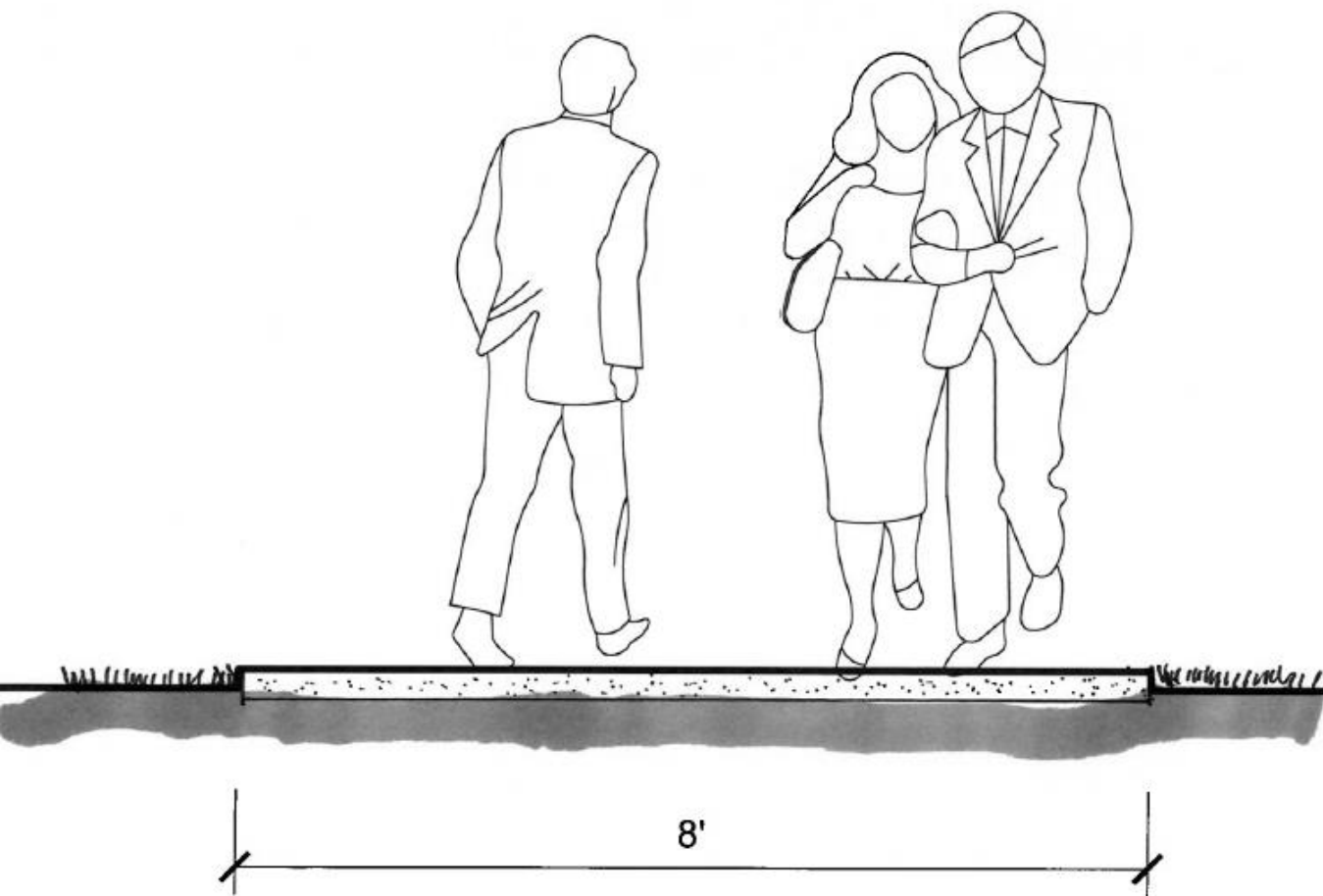

PANFISH TRAIL SECTIONS



